

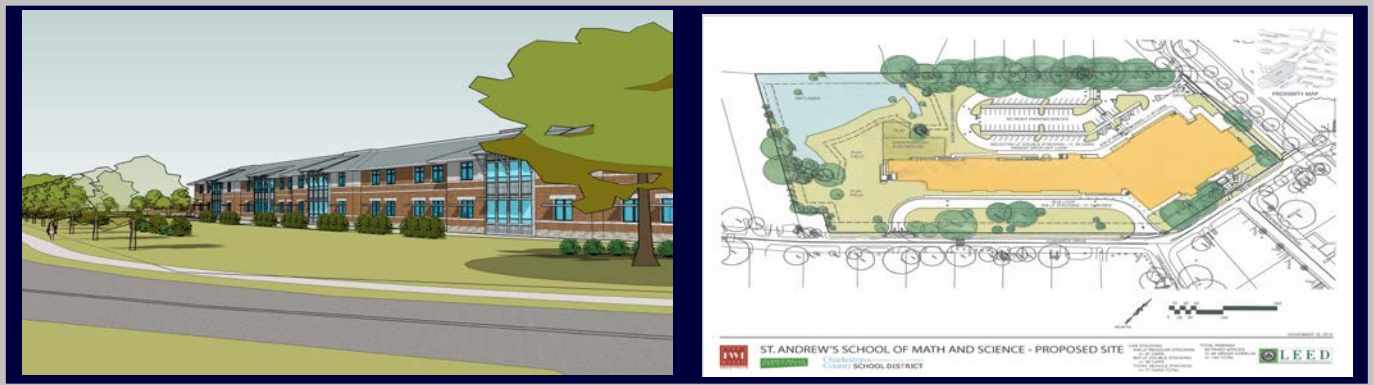

Monthly Executive Summary Report
Reflects Previous Month's Activity

St. Andrews School of Math and Science
Constituent District 10



Project Team

Associate Superintendent: Terri Nichols

Principal: Mark Shea

Project Manager: Jay Poston

Architectural Firm: The FWA Group/Clancy Wells

General Contractor: TBD

Site Manager: TBD

Design Architect: Dale Strecker

Project Scope:

Construction of a new two-story 750-student K-5 facility on the existing site. The facility will include 36 instructional spaces with complementary support areas as indicated in the Educational Specifications. The existing facility will be demolished prior to the start of construction. Students will use the old Oakland Elementary school campus for swing space during the approximate two year construction.

Budget:

Original Budget: \$33.1 million

Revised Budget:

Date: November 2, 2010

Date:

Schedule:

Design: July 2012

Construction: September 2012 – January 2015

Solicitation: August 2012

Schedule Issues: Commence analysis of swing space modification/design package

Major Issues: Analysis of swing space/preparation of modification design package
Completion of building design package
Swing space site construction and facility preparation

Achievements: Completion of Schematic Design (35%) Documents package



Monthly Executive Summary Report
Reflects Previous Month's Activity
St. Andrews School of Math and Science
Constituent District 10

Phasing/Mobile Classrooms:

Construction on the existing site will be accomplished in one phase. The old Oakland Elementary campus will be used as swing space with additional mobile classroom units located on site to accommodate the entire student population for the duration of the construction process.



Monthly Executive Summary Report
 Reflects Previous Month's Activity
St. Andrews School of Math and Science
 Constituent District 10

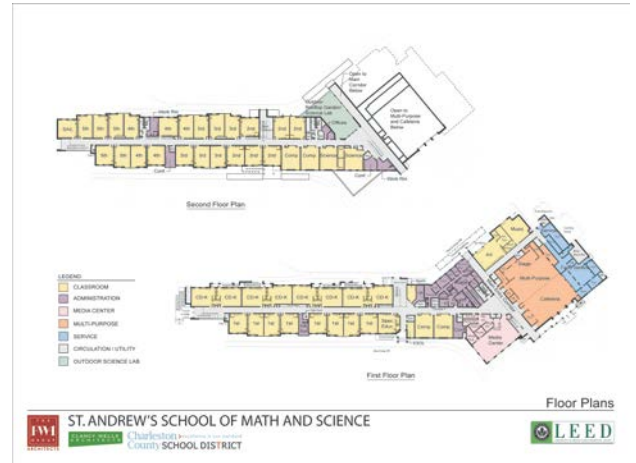

Rear Elevation View

Preliminary Floor Plan

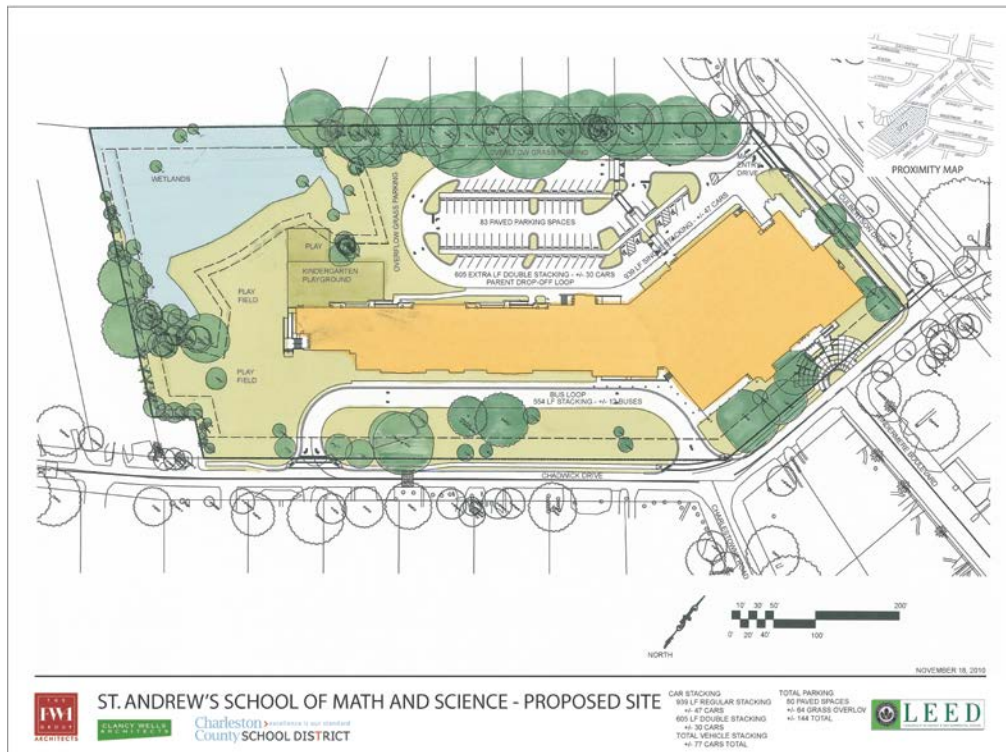

Enlarged Site Plan



Monthly Executive Summary Report
Reflects Previous Month's Activity
St. Andrews School of Math and Science
Constituent District 10