

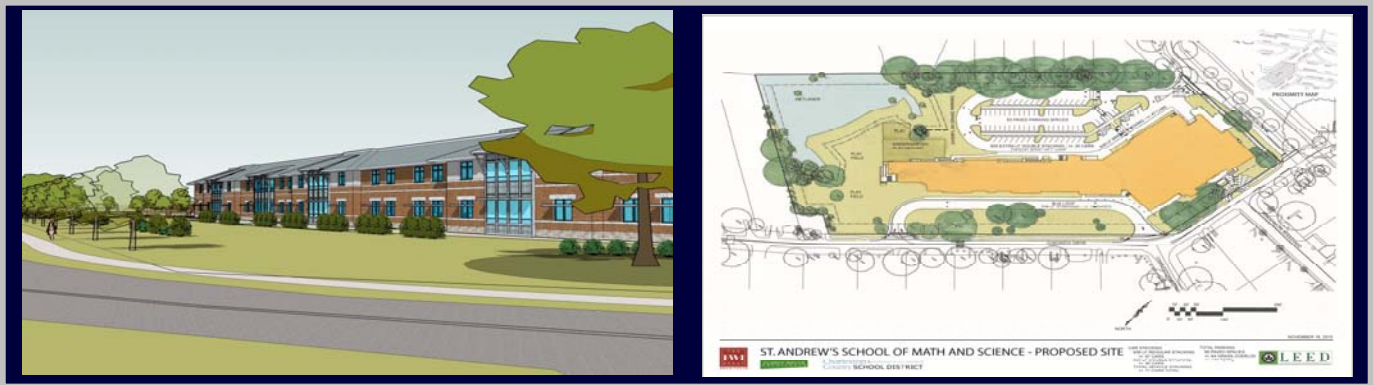

**Monthly Executive Summary Report**  
Reflects Previous Month's Activity

**St. Andrews School of Math and Science**  
Constituent District 10



**Project Team**

**Associate Superintendent:** Terri Nichols  
**Principal:** Mark Shea  
**Project Manager:** Jay Poston  
**Architectural Firm:** The FWA Group/Clancy Wells  
**General Contractor:** TBD  
**Site Manager:** TBD  
**Design Architect:** Dale Strecker

**Project Scope:**

Construction of a new two-story 750-student K-5 facility on the existing site. The facility will include 36 instructional spaces with complementary support areas as indicated in the Educational Specifications. The existing facility will be demolished prior to the start of construction. Students will use the old Oakland Elementary school campus for swing space during the approximate two year construction.

**Budget:**

**Original Budget:** \$33.1 million  
**Revised Budget:**  
**Date:** November 2, 2010  
**Date:**

**Schedule:**

**Design:** July 2012  
**Construction:** September 2012 – January 2015  
**Solicitation:** August 2012

**Schedule Issues:** Analysis of swing space modification complete. Proposal pending.

**Major Issues:** Analysis of swing space/preparation of modification design package  
 Completion of building design package  
 Swing space site construction and facility preparation

**Achievements:** Completion of Schematic Design (35%) Documents package



## Monthly Executive Summary Report

Reflects Previous Month's Activity

# St. Andrews School of Math and Science

Constituent District 10

### ***Phasing/Mobile Classrooms:***

Construction on the existing site will be accomplished in one phase. The old Oakland Elementary campus will be used as swing space with additional mobile classroom units located on site to accommodate the entire student population for the duration of the construction process.



**Monthly Executive Summary Report**  
 Reflects Previous Month's Activity  
**St. Andrews School of Math and Science**  
 Constituent District 10

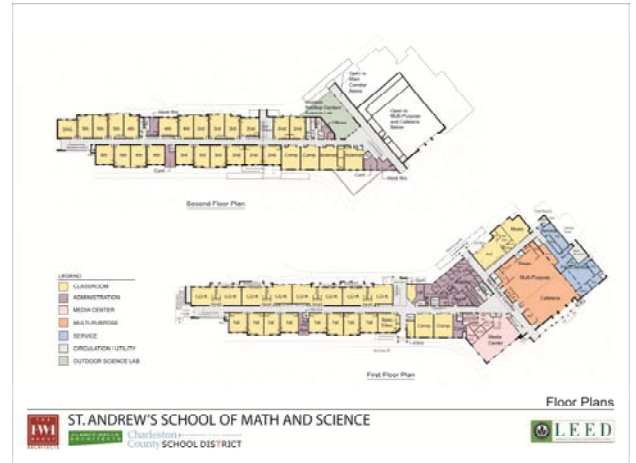

**Rear Elevation View**

**Preliminary Floor Plan**

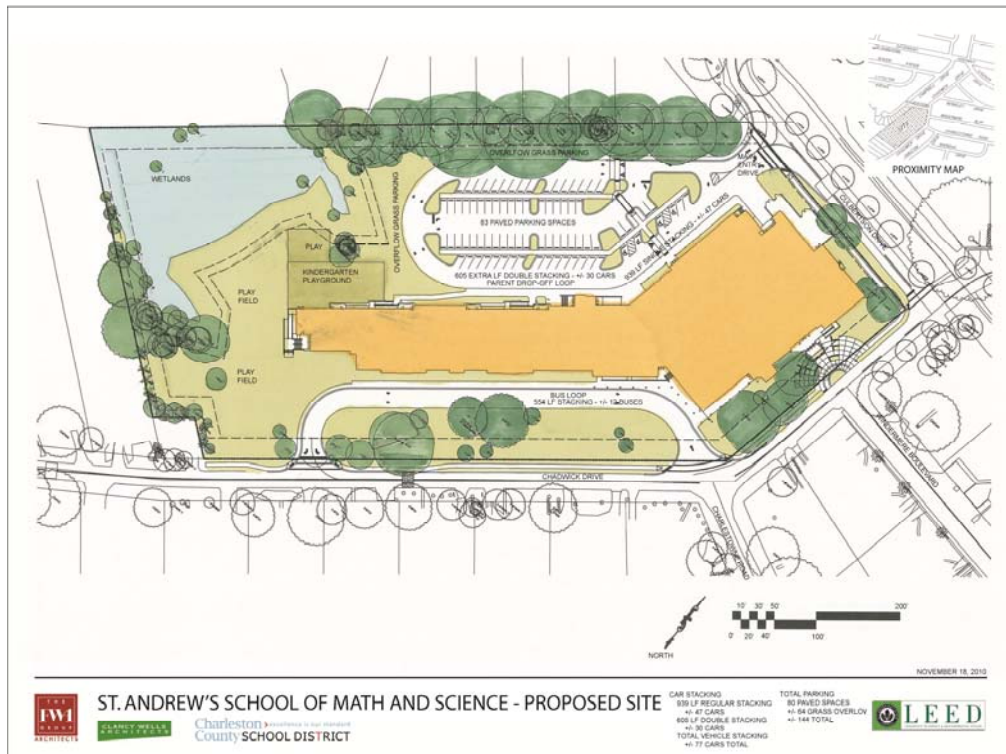

**Enlarged Site Plan**