



Monthly Executive Summary Report
Reflects Previous Month's Activity
Mount Pleasant Academy
Constituent District 2



Project Team

Associate Superintendent: Dr. Lynda Davis

Principal: Jane McGee Davis

Project Manager: Ed Strack

Site Manager: Larry Jordon

Architectural Firm: Stubbs Muldrow Herin

Design Architect: Judy Dixon, AIA, LEED AP

General Contractor: Brantley Construction Company, LLC

Project Scope:

Existing facility is demolished and a new 64,000 sf two story facility will be constructed. The new facility will have a capacity of 500 K-5 students. The new facility will include 26 teaching stations plus science and special Ed spaces. Facility will also include a 3,000 sf multipurpose room.

Budget:

Original Budget: \$16.2 million

Date: May 10, 2006

Revised Budget: \$18.2 million

Date: April 9, 2007

Schedule:

Design: January 2008 Solicitation: February 2008 Construction completion: August 2009

Schedule Issues: None at this time.

Major Issues:

None

Achievements:

Work is currently underway.

Completed Education Specifications and Programming.

Completed coordination w/ the Town of Mount Pleasant addressing parking and drives.

Bid and Award has been completed for the general construction package. The contractor is on site installing the building foundations. Steel delivery is expected to arrive mid June.

Phasing/Mobile Classrooms:



SOUTHERN MANAGEMENT GROUP

May 2008



Monthly Executive Summary Report
Reflects Previous Month's Activity
Mount Pleasant Academy
Constituent District 2

Students have been moved temporarily to a swing campus at the Wando South campus where they will remain until project is complete.

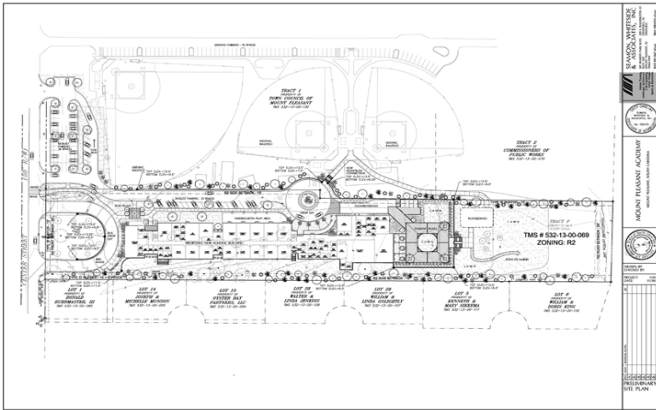

Site Plan



Rendering