



Monthly Executive Summary Report
Reflects Previous Month's Activity
Mount Pleasant Academy
Constituent District 2



Project Team

Associate Superintendent: Terri Nichols

Principal: Jane McGee Davis

Project Manager: Ed Strack

Site Manager: Larry Jordon

Architectural Firm: Stubbs Muldrow Herin

Design Architect: Judy Dixon, AIA, LEED AP

General Contractor: Brantley Construction Company, LLC

Project Scope:

Existing facility is demolished and a new 64,000 sf two story facility will be constructed. The new facility will have a capacity of 500 K-5 students. The new facility will include 26 teaching stations plus science and special Ed spaces. Facility will also include a 3,000 sf multipurpose room.

Budget:

Original Budget: \$16.2 million

Date: May 10, 2006

Revised Budget: \$18.2 million

Date: April 9, 2007

Current Status:

Erection of steel is now in process at the multipurpose area. The foundation wall along the north erection is complete. Concrete placement for the first floor in the administrative area is complete. Foundation masonry is now complete. Second story steel erection in progress.

Schedule:

Design: January 2008

Solicitation: February 2008

Construction completion: August 2009

Schedule Issues: None at this time.

Major Issues: None.

Achievements:

Steel erection is in progress.

North retaining wall is complete.

Privacy fence at property line is complete. First floor concrete slabs complete.

Second floor concrete slabs in progress.

Roof decking for multi-purpose area in progress.





Monthly Executive Summary Report
Reflects Previous Month's Activity
Mount Pleasant Academy
Constituent District 2

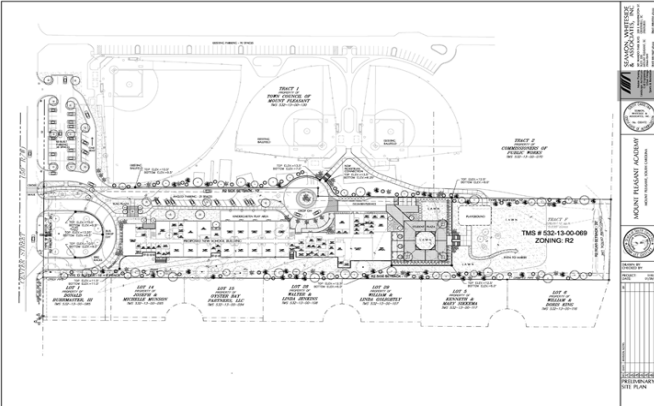

Site Plan



Rendering