



Monthly Executive Summary Report
Reflects Previous Month's Activity
Mount Pleasant Academy
Constituent District 2



Project Team

Associate Superintendent: Dr. Lynda Davis

Principal: Jane McGee Davis

Project Manager: Ed Strack

Site Manager: Larry Jordon

Architectural Firm: Stubbs Muldrow Herin

Design Architect: Judy Dixon, AIA, LEED AP

General Contractor: Brantley Construction Company, LLC

Project Scope:

Existing facility is demolished and a new 64,000 sf two story facility will be constructed. The new facility will have a capacity of 500 K-5 students. The new facility will include 26 teaching stations plus science and special Ed spaces. Facility will also include a 3,000 sf multipurpose room.

Budget:

Original Budget: \$16.2 million

Date: May 10, 2006

Revised Budget: \$18.2 million

Date: April 9, 2007

Schedule:

Design: January 2008 Solicitation: February 2008 Construction completion: August 2009

Schedule Issues: None at this time.

The Phase I demo and site package has been completed. The Phase II early site package is expected to be completed by January, 2008. During this time final preparations for completion of the Construction Documents will be in progress. Advertisements for construction bids are scheduled for February, 2008.

Major Issues:

None

Achievements:

Work is currently underway.

Completed Education Specifications and Programming.

Completed coordination w/ the ToMP addressing parking and drives.

Bid and Award has been completed for the Phase II site package. Package bid within budget.



Monthly Executive Summary Report
Reflects Previous Month's Activity
Mount Pleasant Academy
Constituent District 2

Completed design development phase.
Submitted 100% construction documents for review.

Phasing/Mobile Classrooms:

Students have been moved temporarily to a swing campus at the Wando South campus where they will remain until project is complete.



Monthly Executive Summary Report
Reflects Previous Month's Activity
Mount Pleasant Academy
Constituent District 2

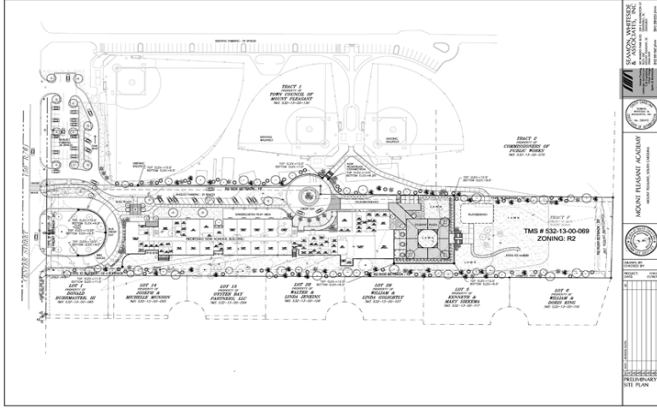

Site Plan

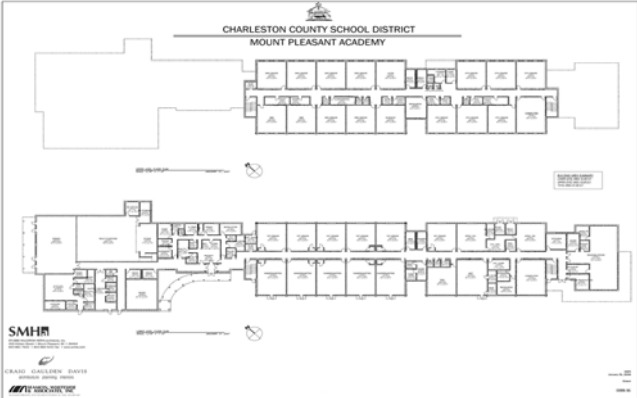

Floor Plan

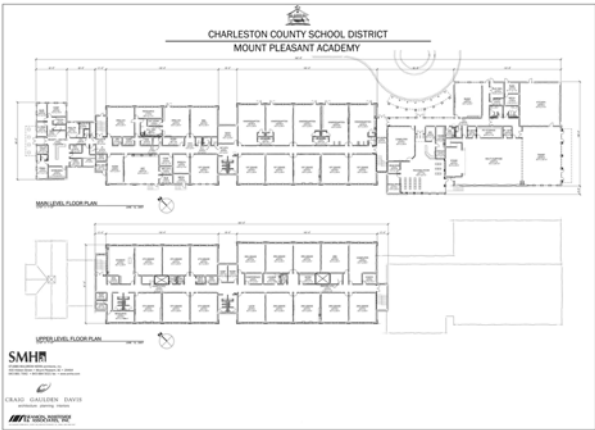

Schematic Design



Rendering