



Monthly Executive Summary Report  
Reflects Previous Month's Activity  
**Mount Pleasant Academy**  
Constituent District 2



***Project Team***

**Associate Superintendent: Dr. Lynda Davis**

**Principal: Jane McGee Davis**

**Project Manager: Ed Strack**

**Site Manager: Larry Jordon**

**Architectural Firm: Stubbs Muldrow Herin**

**Design Architect: Judy Dixon, AIA, LEED AP**

**General Contractor: To Be Determined**

***Project Scope:***

Existing facility is demolished and a new 64,000 sf two story facility will be constructed. The new facility will have a capacity of 500 K-5 students. The new facility will include 26 teaching stations plus science and special Ed spaces. Facility will also include a 3,000 sf multipurpose room.

***Budget:***

**Original Budget: \$16.2 million**

**Date: May 10, 2006**

**Revised Budget: \$18.2 million**

**Date: April 9, 2007**

***Schedule:***

**Design: January 2008      Solicitation: February 2008      Construction completion: August 2009**

**Schedule Issues: None at this time.**

The Phase I demo and site package has been completed. The Phase II early site package is expected to be completed by January, 2008. During this time final preparations for completion of the Construction Documents will be in progress. Advertisements for construction bids are scheduled for February, 2008.

***Major Issues:***

**none**

***Achievements:***

**Completed Education Specifications and Programming.**

**Completed coordination w/ the ToMP addressing parking and drives.**

**Bid and Award has been completed for the Phase II site package. Package bid within budget.**

**Completed design development phase.**

**Submitted 100% construction documents for review.**



**Monthly Executive Summary Report**  
Reflects Previous Month's Activity  
**Mount Pleasant Academy**  
Constituent District 2

*Phasing/Mobile Classrooms:*

Students have been moved temporarily to a swing campus at the Wando South campus where they will remain until project is complete.



Monthly Executive Summary Report  
Reflects Previous Month's Activity  
**Mount Pleasant Academy**  
Constituent District 2

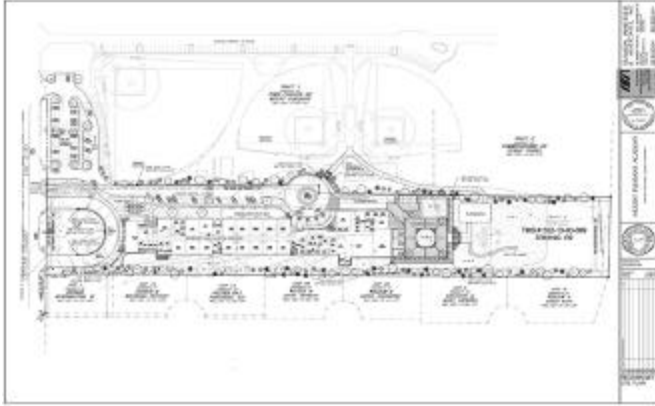

**Site Plan**



**Floor Plan**



**Schematic Design**



**Rendering**