

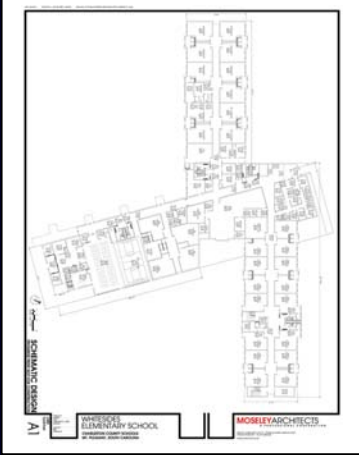

Monthly Executive Summary Report
Whitesides Elementary
 Constituent District 2

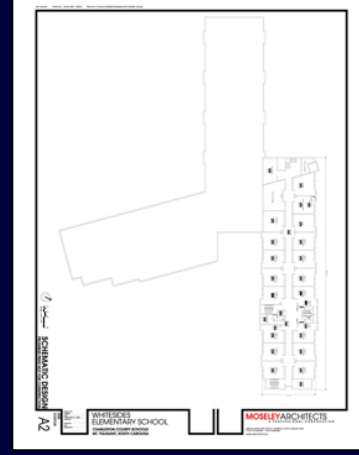

First Floor Plan



Second Floor Plan

Project Team

Associate Superintendent: Dr. Nancy McGinley
Principal: Lona Pounder
Project Manager: Jack Burgess
Architectural Firm: Moseley Architects
General Contractor: Brantley Construction, Inc.

Site Manager: Steve Youngs
Design Architect: Chad Volk

Project Scope: Construction will consist of a new 97,500 sf. elementary school (k-5) consisting of approximately 38 classrooms, administration area, multipurpose room, kitchen, cafeteria, courtyards and play areas. There will be controlled access entrances with separate drop off areas for buses and parents with parking for guest and staff. The building will be steel and masonry with the most up to date mechanical, electrical and control systems. Special features include state of the art security, fire protection monitoring, PA and data. The project construction will include an early site work package that will result in the site being ready for building construction at the time of the general contractor award.

Budget:

Original Budget: \$21.5 Million
Revised Budget: \$22.8 Million

Date: 5-10-2006
Date: 4-09-2007



Schedule:

Design: July 2008 **Solicitation:** September 2008 **Substantial Completion:** December 2009



Schedule Issues: There are none at this time.

Major Issues: There are none at this time.

Achievements: The Early Site Package will be complete October 1, 2008.

Phasing/Mobile Classrooms: None required - Project will be constructed on a new site while classes continue at the school's current location.



Monthly Executive Summary Report

Whitesides Elementary

Constituent District 2

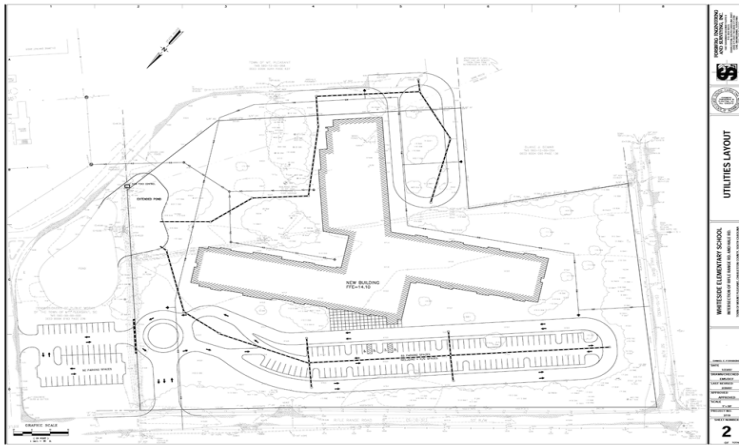

Site Plan