

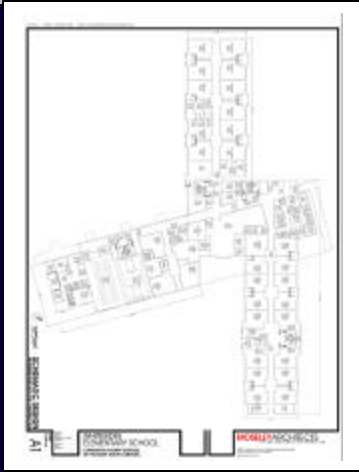

Monthly Executive Summary Report

Whitesides Elementary

Constituent District 2



First Floor Plan



Second Floor Plan

Project Team

Associate Superintendent: Dr. Lynda Davis
Principal: Lona Pounder
Project Manager: Jack Burgess
Architectural Firm: Moseley Architects

Site Manager: *To Be Determined*
Design Architect: Tom Hughes, AIA

General Contractor: *To Be Determined*

Project Scope: Construction will consist of a new 91,200 sf. elementary school (k-5) consisting of approximately 38 classrooms, administration area, multipurpose room, kitchen, cafeteria, courtyards and play areas. There will be controlled access entrances with separate drop off areas for buses and parents with parking for guest and staff. The building will be steel and masonry with the most up to date mechanical, electrical and control systems. Special features include state of the art security, fire protection monitoring, PA and data. The project construction will include an early site work package that will result in the site being ready for building construction at the time of the general contractor award.

Budget:

Original Budget: \$21.5 Million
Revised Budget: \$22.8 Million

Date: 5-10-2006
Date: 4-10-2007

Schedule:

Design: November 2007 **Solicitation:** March 2008 **Construction End Date:** January 2010

Schedule Issues: None at this time.

Major Issues: Land acquisition

Achievements: Completed Schematic Design Phase. Coordination meetings with the Mount Pleasant water department have been positive. Site access entry location has been identified.



Monthly Executive Summary Report
Whitesides Elementary
Constituent District 2

Phasing/Mobile Classrooms: None Required - Project will be constructed on a new site while classes continue at the school's current location.



Monthly Executive Summary Report
Whitesides Elementary
Constituent District 2

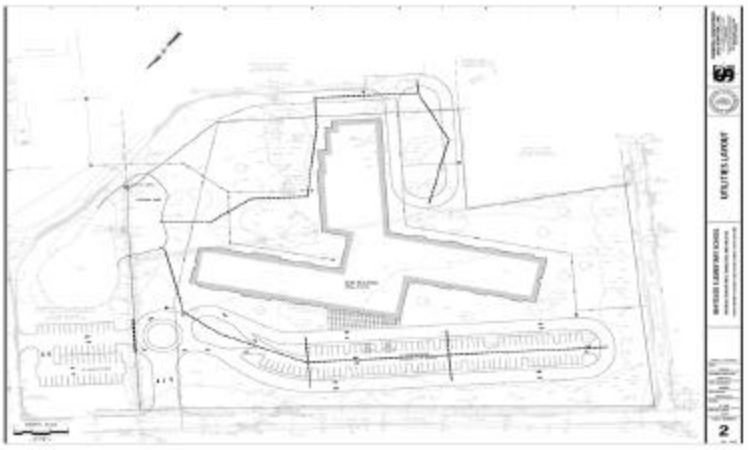

Site Plan