

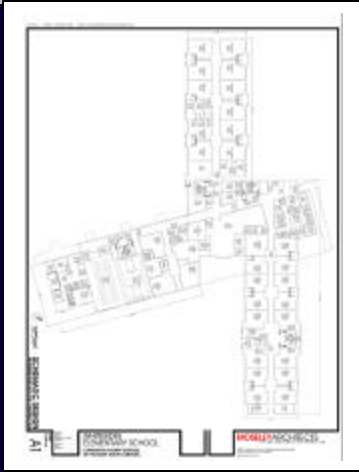

# Monthly Executive Summary Report

## Whitesides Elementary

### Constituent District 2



First Floor Plan



Second Floor Plan

#### ***Project Team***

**Associate Superintendent:** Dr. Lynda Davis  
**Principal:** Lona Pounder  
**Project Manager:** Jack Burgess  
**Architectural Firm:** Moseley Architects

**Site Manager:** *To Be Determined*  
**Design Architect:** Tom Hughes, AIA

**General Contractor:** *To Be Determined*

**Project Scope:** Construction will consist of a new 91,200 sf. elementary school (k-5) consisting of approximately 38 classrooms, administration area, multipurpose room, kitchen, cafeteria, courtyards and play areas. There will be controlled access entrances with separate drop off areas for buses and parents with parking for guest and staff. The building will be steel and masonry with the most up to date mechanical, electrical and control systems. Special features include state of the art security, fire protection monitoring, PA and data. The project construction will include an early site work package that will result in the site being ready for building construction at the time of the general contractor award.

#### ***Budget:***

**Original Budget:** \$21.5 Million  
**Revised Budget:** \$22.8 Million

**Date:** 5-10-2006  
**Date:** 4-10-2007

#### ***Schedule:***

**Design:** November 2007      **Solicitation:** March 2008      **Construction End Date:** January 2010

**Schedule Issues:** None at this time.

**Major Issues:** Land acquisition

**Achievements:** Completed Schematic Design Phase. Design document reviews scheduled for July 26, 2007..



**Monthly Executive Summary Report**  
**Whitesides Elementary**  
**Constituent District 2**

*Phasing/Mobile Classrooms: None required - Project will be constructed on a new site while classes continue at the school's current location.*



# Monthly Executive Summary Report

## Whitesides Elementary

### Constituent District 2

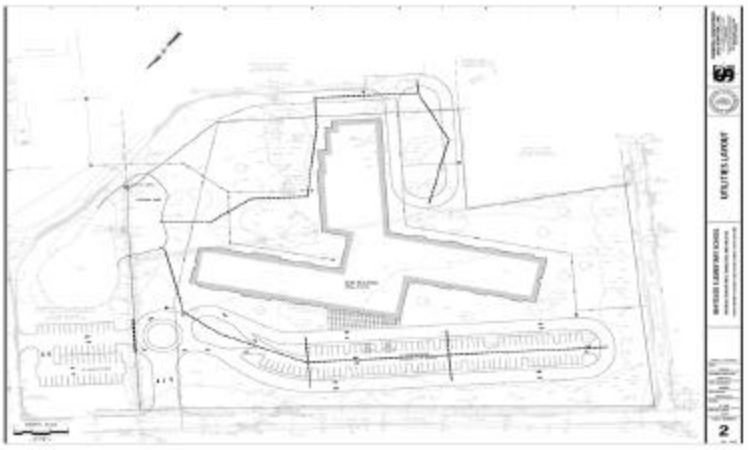

Site Plan